

State of Wyoming Corner Record

(In compliance with the CORNER PERPETUATION AND FILING ACT, Wyoming Statutes, 1997 Section 33-29-140 et. seq., and the Rules and Regulations of the Board of Professional Engineers and Professional Land Surveyors)
Reverse side of this form may be used if more space is needed.

Record of original survey and citation of source of historical information (if corner is lost or obliterated). Description of corner monumentation evidence found and/or monument and accessories established to perpetuate the location of this corner. Sketch of relative location of monument, accessories, and reference points with course and distance to adjacent corner(s) (if determined in this survey). Method and rationale for reestablishment of lost or obliterated corner.

RECORD: SET A CONGLOMERATE STONE 14X10X8 FOR ¼ SEC.COR.

MONUMENT FOUND: FOUND 24X10X3 CONGLOMERATE STONE LYING LOOSE NO MARKINGS

MONUMENT SET: SET 2½" ALUMINUM CAP STAMPED PLS 5910

REFERENCES: NONE

RECP #: 698896
RECORDED 12/23/2016 AT 3:14 PM BK# 2528 PG# 1229
 Debra K. Lee, CLERK OF LARAMIE COUNTY, WY PAGE 1 OF 1

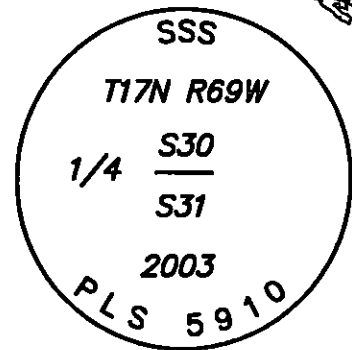
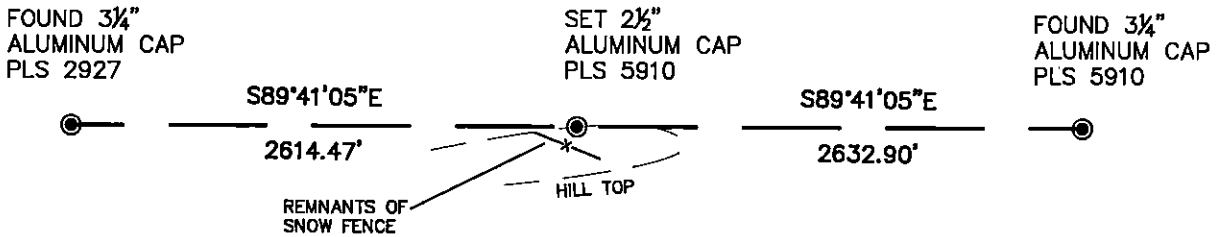

DRAWING NOT TO SCALE

Date of Field Work: 02/03/03

Office Reference: 03116

Monument Inscription

Cross Index Plat

	1	2	3	4	5	6	7	8	9	10	11	12	13	14	15	16	17	18	19	20	21	22	23	24	25		
A	+	+	+	+	+	+	+	+	+	+	+	+	+	+	+	+	+	+	+	+	+	+	+	+	+	B	
B																											C
C		6		5		4		3		2		1															D
D	+	+	+	+	+	+	+	+	+	+	+	+	+	+	+	+	+	+	+	+	+	+	+	+	+	+	E
E																											F
F																											G
G		7		8		9		10		11		12															H
H	+	+	+	+	+	+	+	+	+	+	+	+	+	+	+	+	+	+	+	+	+	+	+	+	+	+	I
I																											J
J																											K
K	+	+	+	+	+	+	+	+	+	+	+	+	+	+	+	+	+	+	+	+	+	+	+	+	+	+	L
L		18		17		16		15		14		13															M
M	+	+	+	+	+	+	+	+	+	+	+	+	+	+	+	+	+	+	+	+	+	+	+	+	+	+	N
N																											O
O																											P
P		19		20		21		22		23		24															Q
Q	+	+	+	+	+	+	+	+	+	+	+	+	+	+	+	+	+	+	+	+	+	+	+	+	+	+	R
R																											S
S																											T
T		30		29		28		27		26		25															U
U	+	+	+	+	+	+	+	+	+	+	+	+	+	+	+	+	+	+	+	+	+	+	+	+	+	+	V
V																											W
W																											X
X		31		32		33		34		35		36															Y
Y	+	+	+	+	+	+	+	+	+	+	+	+	+	+	+	+	+	+	+	+	+	+	+	+	+	+	Z
Z																											

Firm/Agency, Address

STEIL SURVEYING SERVICES LLC

1102 West 19th Street

Cheyenne, Wyoming 82001

Telephone Number: **(307) 634-7273**

This corner record was prepared by me or under my direction and supervision.

SEAL & SIGNATURE



Corner Name NORTH QUARTER Section 31, T 17 N, R 69 W, 6th P.M.

Cross-Index No.: V-3

County: LARAMIE Wyoming

SBRPEPLS/PLSW: March 1994; PLSW January 1998